



LIGHTING • RIGGING • POWER STRUCTURES • MOBILES • STAGING • DESIGN

Gig Rig

A unique roadshow and broadcasting facility in the form of an articulated truck. Suitable for exhibitions, roadshows, outside broadcasts and corporate entertainment. The Gig Rig is configurable with a 10ft x 8ft or 23ft x 13ft stage area and is complete with a fully equipped sound system and DJ area. An air conditioned hospitality area with fridge, microwave and coffee facilities provides a comfortable guest area.



Specifications

Construction	Twin axle trailer with side flap and roof handrails
Size	33ft x 8ft x 13ft high (45ft long with tractor unit)
Weight	11 tonnes (16 tonnes with tractor unit)
Stage Sizes	Small stage 10ft wide x 8ft deep x 4ft high Large stage 23ft wide x 13ft deep x 4ft high
Masts	1 x 10m, 1 x 15m pneumatic masts
Windows	Tinted glass windows
Branding	10 areas for company logos plus 2 flag poles
PA System	8kW Deltamax PA system with mixing desks and accessories
Control Room	Audio & video facilities with phones and AVR
Power Source	32A or 63A single phase, optional on-board 5KVA generator
Air Conditioning	Twin ceiling mounted air conditioning units

F1 Studio

The F1 Studio is a self-climbing studio facility designed to allow an interview studio / commentary position to be located in areas where space is at a premium. This unique design allows a studio to be positioned on top of a standard television scanner vehicle.

Specifications

Enclosure	Steel / Foam laminated pre-assembled panels mounted on aluminium extrusion.
Studio Size	Floor area 6m x 4.5m giving an area of 27m ² (290ft ²). Height to apex 3.6m
Exterior Finish	Natural aluminium with anodised aluminium extrusions, silver grey roof and wall panels.
Interior Finish	Carpeted floor, walls and ceiling with ample provision for lighting bars in the enclosure roof.
Windows	Nine triple glazed 1200mm x 1800mm window units using neutral density Makrolon.
Exterior Covering	Silver grey PVC roof covering and skirt to UK BS5438 Test 2.
Access	Three-flight free standing staircase. Emergency exit onto scanner roof.
Power	32A 3 phase power via CEE-17 connector required for assembly.
Weight	Total weight of assembly not including furnishings etc. 8,000Kg.



Instant Office

This mobile production vehicle is the perfect solution for an on-site production office space where your location is frequently changing. With ample storage space for your office equipment, documentation and personal belongings, the Instant Office allows you to arrive on site and start work with no time wasted setting up.

Specifications

Vehicle	9.5m long x 2.4m wide x 3.75m high
Power	32A single phase supply (client must supply)
Phones	Integral 2 line 6 extension phone system
Catering	Kitchenette with microwave, cooker rings, sink and kettle
A/V	Stereo CD/Cassette system and two 14" TV monitors
Seating	Workstations for up to six persons
Facilities	Shower, sink and toilet
Air Con	Twin roof-mounted air conditioning units
Options	Photocopier and fax machine available on request

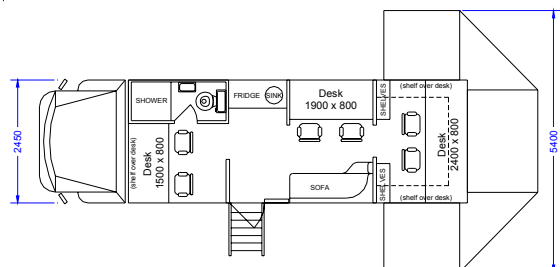

ELSTREE LIGHT & POWER PLC

HEAD OFFICE AND NATIONAL DISTRIBUTION CENTRE:

HANGAR 15 ALCONBURY AIRFIELD HUNTINGTON CAMBRIDGESHIRE PE28 4WX T: 01480 443500 F: 01480 443888

WWW.ELP.TV



LIGHTING • RIGGING • POWER
STRUCTURES • MOBILES • STAGING • DESIGN

Mobile Production Trailers

A range of three Mobile Production Trailers providing clean and warm production office or hospitality space on site or on location. These spacious self contained trailers can be rapidly deployed on location giving you the comfort of your permanent office within hours of arriving on site.

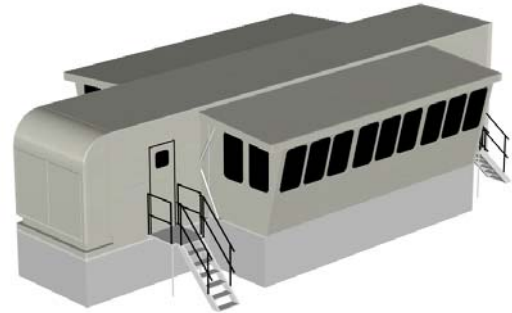

Specifications

Construction	45ft twin axle trailer with hydraulic gull-wing extending sides
Interior Finish	Dark grey heavy duty carpet on floor and side walls
Windows	Tinted glass windows, tinted glass port holes in personnel doors
Power Source 1	63A 3 phase mains on CEE-17 connector
Power Source 2	On-board diesel generator
Personnel access	Doors with external landings and stairs with handrails
Equipment access	Double loading doors at rear of trailer for large equipment (2.1m wide x 2m high)
Lighting	Ceiling mounted fluorescent lights Battery maintained emergency lights 12V fluorescent lighting External lights on PIR sensors adjacent to all personnel doors
Power distribution	13A and 32A sockets in floor traps
Data distribution	Cat 5 structured cabling in floor traps
Air conditioning	Ceiling mounted air conditioning units Night heaters
Intruder Alarm	PIR sensors and door contacts on all doors
Fire Alarm	2 x smoke detectors

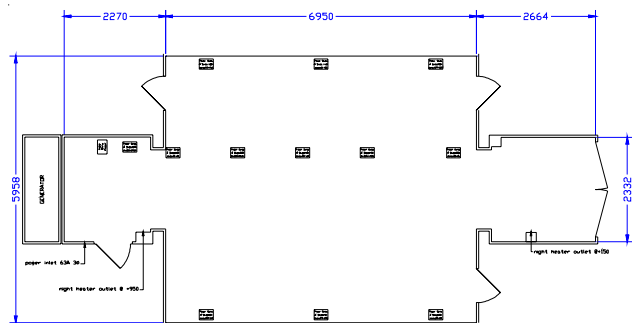

Typical Floor plan

Dimensions	Unit #1	Unit #2	Unit #3
	12 Window Double Sided	9 Window Double Sided	9 Window Single Sided
Floor Area	60m ² (650ft ²)	52m ² (564ft ²)	37m ² (400ft ²)
Overall Size	12.9 L x 7.3 W x 3.9 H	12.9 L x 7.3 W x 3.9 H	12.9 L x 4.9 W x 3.9 H

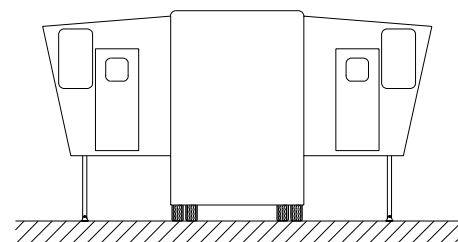
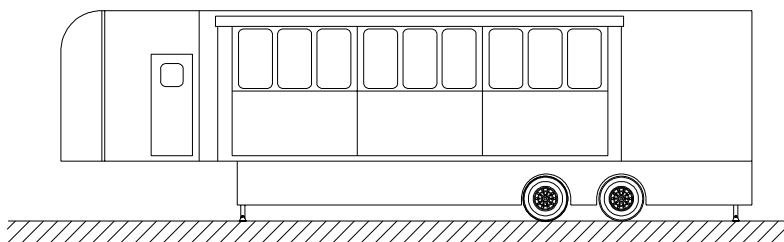

ELSTREE LIGHT & POWER PLC

HEAD OFFICE AND NATIONAL DISTRIBUTION CENTRE:

HANGAR 15 ALCONBURY AIRFIELD HUNTINGTON CAMBRIDGESHIRE PE28 4WX T: 01480 443500 F: 01480 443888

WWW.ELP.TV